

Product information

VELUX INTEGRA[®] flat roof window CVP



Product description

- Mains powered, vented window for flat roofs
- Control pad or remote control
- Pre-installed hidden window operator
- Silent motor operation
- Rain sensor ensures that the window closes automatically in case of rain
- Easy installation of mains powered decoration and sunscreening products
- Wear-resistant, high quality white PVC frame
- Low energy insulating glass unit
- Protective dome
- Maintenance-free surfaces

Roof pitch

- Can be installed in roof pitches between 0° and 15°

Materials

- Extruded PVC
- Glass, laminated inner pane
- VELUX ThermoTechnology™ insulation
- Acrylic or polycarbonate dome

Downloads

For installation instructions, CAD drawings, 3D BIM objects, 3D GDL objects etc, please visit velux.rs.

Certifications



The VELUX product factories guarantee quality systems implementation process and environmental management systems through appropriate accreditations ISO 9001 and ISO 14001

EUTR In compliance with the EU Timber Regulation (EUTR), EU regulation 995/2010

REACH We are aware of the REACH regulation and acknowledge the obligations. No products are obliged to be registered in accordance to REACH and none of our products contain any Substances of Very High Concern.

Available sizes and daylight area

	600 mm	800 mm	900 mm	1000 mm	1200 mm	1500 mm
600 mm	CVP 060060 (0.19)					
800 mm		CVP 080080 (0.40)				
900 mm	CVP 060090 (0.32)		CVP 090090 (0.54)			
1000 mm				CVP 100100 (0.70)		
1200 mm			CVP 090120 (0.76)		CVP 120120 (1.07)	
1500 mm				CVP 100150 (1.11)		CVP 150150 (1.78)

() = Effective daylight area, m²

Lining measurements

Size	W x H mm
060060	559x559
080080	759x759
060090	559x859
090090	859x859
090120	859x1159
100100	959x959
100150	959x1459
120120	1159x1159
150150	1459x1459

External frame measurements

Size	W x H mm
060060	780x780
080080	980x980
060090	780x1080
090090	1080x1080
090120	1080x1380
100100	1180x1180
100150	1180x1680
120120	1380x1380
150150	1680x1680



VELUX INTEGRA® flat roof window CVP

- is mains powered
- is operated with control pad/remote control supplied with the window
- opens 200 mm – providing good ventilation
- can be combined with fixed flat roof windows for the ultimate combination of natural light and fresh air

Several flat roof windows can be controlled with the same control pad

Width

Height

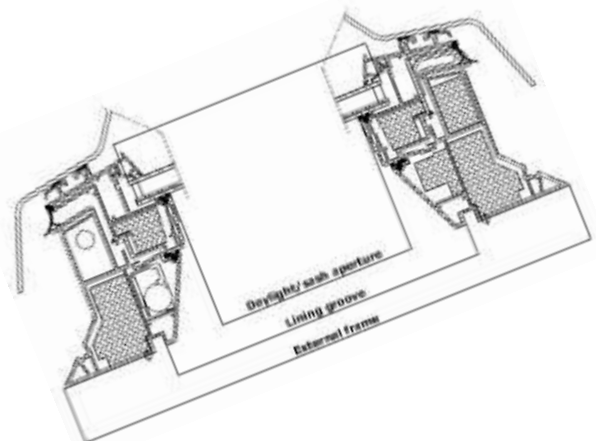
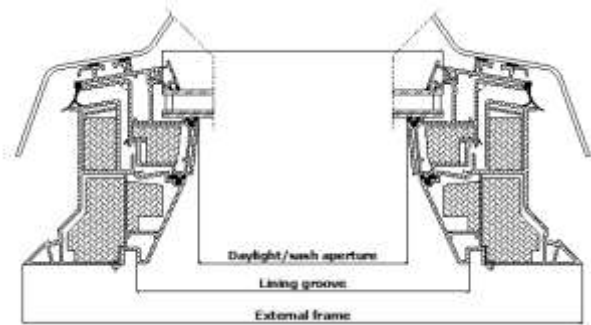

Technical values

Property	Window sizes								
	060060	060090	080080	090090	090120	100100	100150	120120	150150
Ventilation area m ²	0.12	0.14	0.16	0.18	0.20	0.20	0.23	0.24	0.30

Glazing structure

	--63QK	--73FQV	--73UT
Inner glass pane	2 x 4 mm laminated float with low ε coating	2 x 3 mm laminated float with low ε coating	2 x 3 mm laminated float with low ε coating
Outer glass pane	8 mm toughened with coating	4 mm float with coating	4 mm float with coating
Cavity	10.5 mm	14.5 mm	14.5 mm
Glass panes	Double	Double	Double
Gas filling	Krypton	Argon	Argon

Visible features

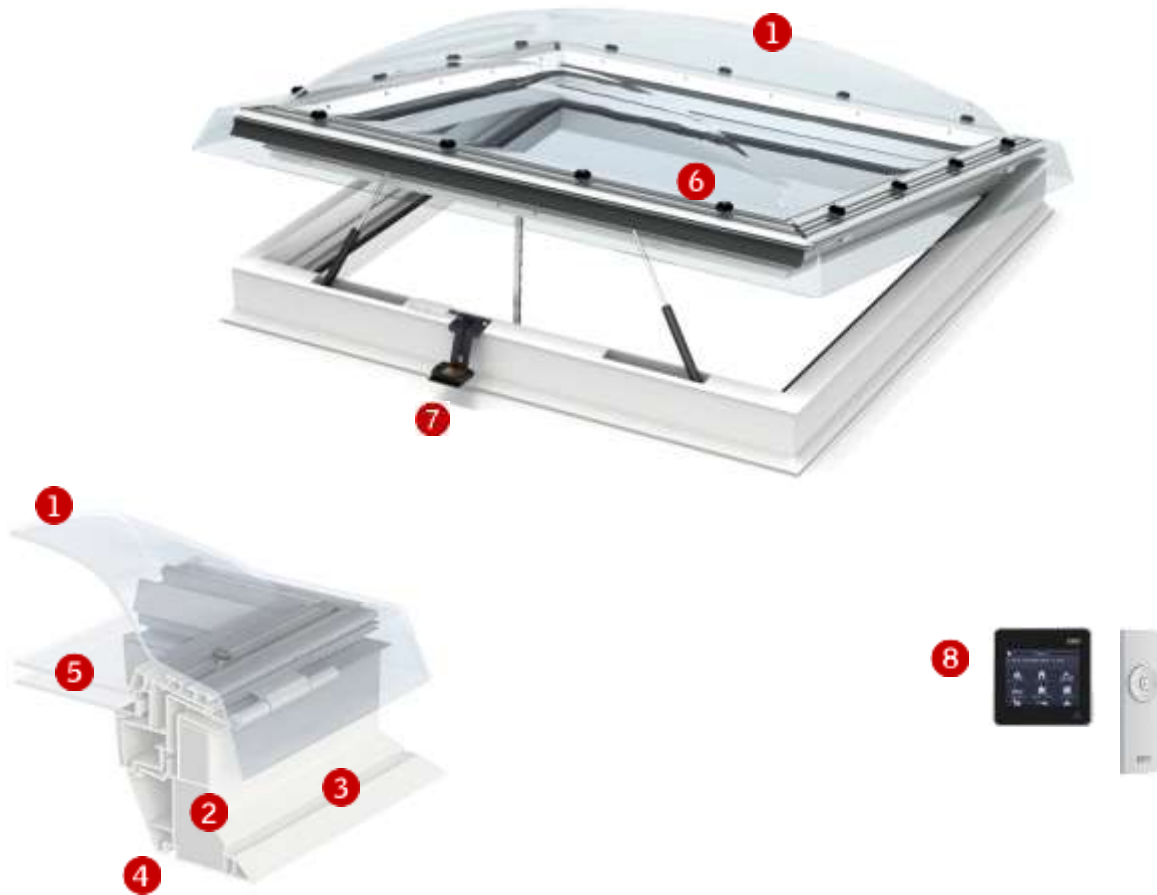

- 1 Dome**
- provides significant rain noise reduction and excellent sound insulation
 - protects the insulating glass unit
 - acrylic or polycarbonate
 - clear or opaque

- 2 Insulation**
- Frame filled with polystyrene for superb insulation.
- Amount of insulation varies depending on variant.

- 3 Frame**
- PVC profiles provide a nice, smooth surface
 - easy cleaning
 - maintenance-free

- 4 Lining groove**
- Unique lining groove makes it easy to build an accurate lining and get a smooth finish

- 5 Insulating glass unit**
- double-glazed
 - inner laminated pane for personal safety

- 6 Dome fittings**
- Anchors make it easy to fit and secure the dome and to remove it for cleaning

- 7 Rain sensor**
- Rain sensor ensures that the window closes automatically if it starts raining

- 8 Control pad**
- Unique VELUX INTEGRA® control pad featuring touch screen with swipe function and pre-set programs - or basic one-way remote control

Cleaning and maintenance

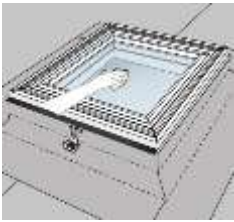

To clean the outer pane of the insulating glass unit, remove the dome from the flat roof window.

Clean the dome with clean water only.

Do not add cleaners/detergents to the water (applies to both insulating glass unit and dome).

Acrylic or polycarbonate dome



- Acrylic dome:
- high light-transmittance makes the acrylic dome ideal for instance at schools, clinics or offices
 - extra scratch-proof
 - available in clear and opaque



- Polycarbonate dome:
- extra impact-resistance and fire protection
 - useful in some industrial buildings where the windows are installed close to fire breaks - or in places with frequent traffic on the roof
 - available in clear and opaque

Interior finish

White PVC profiles	NCS standard colour: S 0500-N, Nearest RAL standard colour: 9016
---------------------------	---

Accessories

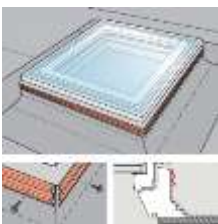

Securing kit ZZZ 210 ensures a safe joint between frame and roofing material



Frame extension with flange ZCE 0015 makes installation in warm or sedum roof constructions possible - extends frame height from 150 mm to 310 mm

Extra frame extension ZCE 1015 can be combined with frame extension with flange ZCE 0015 when frame height exceeding 310 mm is required

One ZCE 0015 can be combined with max three ZCE 1015

Note

We reserve the right to make technical changes.

For more information on VELUX INTEGRA® flat roof window CVP and other VELUX products, please visit velux.rs.

Blinds and awnings



Interior suncreening

- Pleated blind ★
- Double pleated blind ▲



Exterior suncreening

- Awning blind ▲

★ Available in mains powered version

▲ Available in solar powered version

The mains and solar powered versions are part of the VELUX INTEGRA® product range.